



THE SOUTHPORT

TWO STOREY

Y O U R L O T , Y O U R D R E A M , C U S T O M B U I L T .



OVERVIEW

 **3000** SQ. FT.*

 4 BEDROOMS

 **2.5** BATHS

The Southport is spacious and dignified - from the warm entrance to the neat and practical office at the top of the stairs. A graciously formal living and dining room open to the left and right of the large and welcoming front entrance. The kitchen's large center island is a great place to gather as meals are prepared, and the family dining area is warm and inviting. Your family will love to curl up in front of the fireplace on cold winter nights with a cup of hot chocolate and homemade cookies. The second storey will surprise you, with a four piece master bath and exquisite master suite that will please even the most discerning home owner. The spaciousness of the upper floor is complimented by an alluring home office.

NOTES

This image shows a single sheet of white paper with horizontal ruling lines. The lines are evenly spaced and run across the width of the page. There are no margins, text, or other markings on the paper.

Beaverton Design Centre

B32015, Hwy # 12, RR # 3
Beaverton, Ontario L0K 1A0
Tel: 800-392-5493 | Fax: 705-426-9644
Local: 705-426-5113
E: beaverton@royalhomes.com

Gravenhurst Design Centre

2298 Highway 11N
Gravenhurst, Ontario P1P 1R1
Tel: 866-782-0033 | Fax: 705-687-0813
Local: 705-687-3546
E: gravenhurst@royalhomes.com

Innisfil Design Centre

2014 Commerce Park Drive
Innisfil, Ontario L9S 4A3
Tel: 888-739-5122 | Fax: 705-436-5522
Local: 705-436-1001
E: innisfil@royalhomes.com

Minden Design Centre

RR #1, Hwy #35 South, Box 395
Minden, Ontario K0M 2K0
Tel: 888-717-4923 | Fax: 705-286-1394
Local: 705-286-6992
E: minden@royalhomes.com

Peterborough Design Centre

955 Hwy 7 East, RR 7
Peterborough, Ontario K0L 2G0
Tel: 800-659-0980 | Fax: 705-748-5849
Local: 705-748-3283
E: peterborough@royalhomes.com

Wingham Design Centre

40498 Amberley Road
Wingham, Ontario N0G 2W0
Tel: 800-265-3040 | Fax: 519-357-2508
Local: 519-357-2444
E: wsc@royalhomes.com



213 Arthur Street, P.O. Box 370 | Wingham, Ontario, Canada N0G 2W0
Tel: (519) 357.2606 | Toll Free: 1.800.265.3083 | E-mail: Royal@RoyalHomes.com
RoyalHomes.com

*Actual usable floor space may vary from stated floor area. Copyright by Royal Homes. All designs, floor plans and elevations contained herein are the exclusive property of Royal Homes. No home may be constructed in accordance with these plans, except as authorized in writing by the copyright owner. Plans are artist renderings only. For exact dimensions and specifications, please see blueprints.

RoyalHomes.com
1.800.265.3083

THE SOUTHPORT HIGHLIGHTS

3000

SQ. FT.*

- Open & accessible main floor
- Large center island
- Four piece master bath

▶ At Royal Homes, we are committed to creating the home that works for you and your family. With the thousands of custom options available for personalizing every inch of living space, your dream home can be a reality with Royal Homes!

CUSTOMIZATION
& OPTIONS:

- Add more windows to the end in the master ensuite above the tub
- Increase the size of the shower in the ensuite
- Change the closets at the front door - move to by the stairs

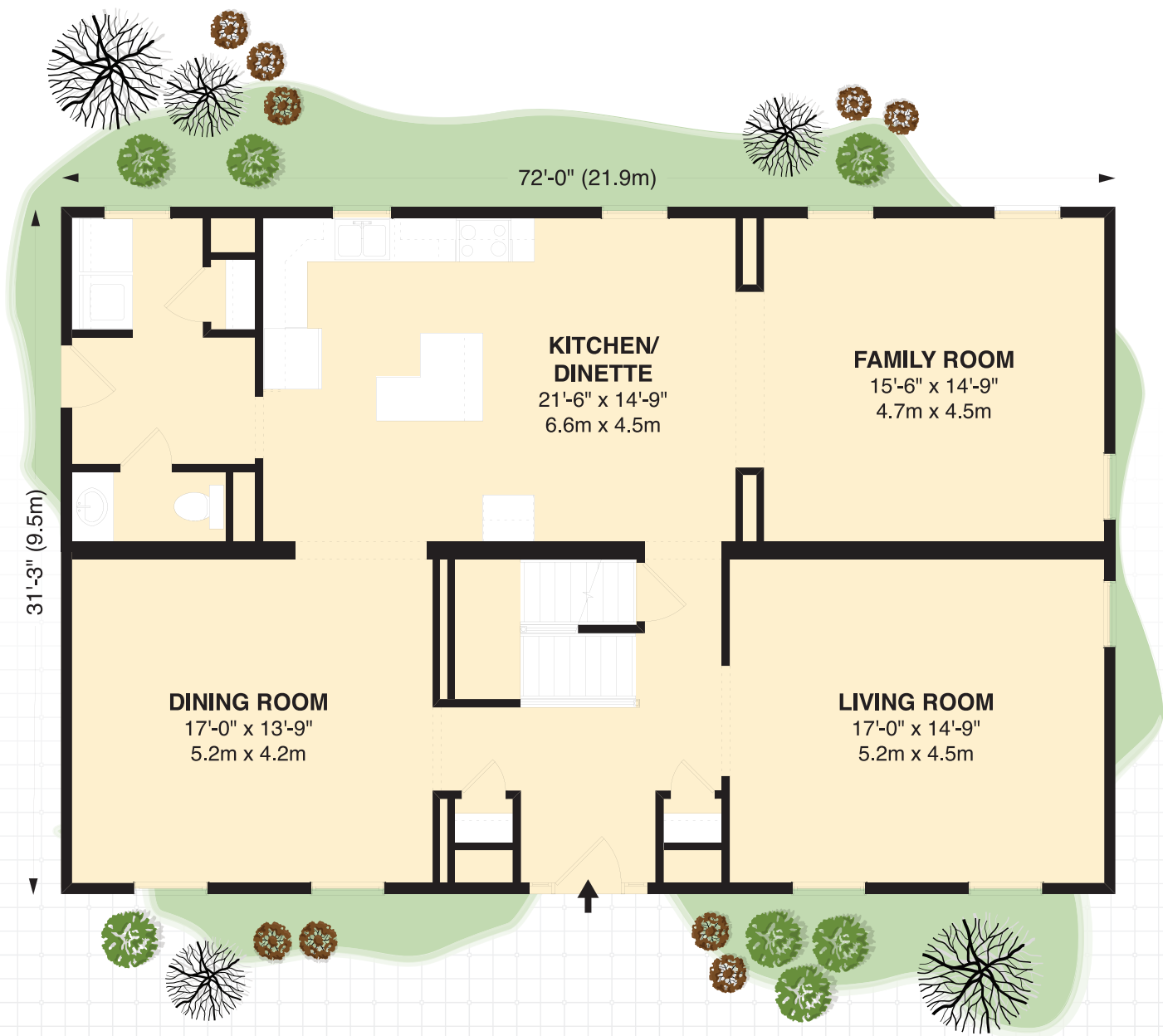

MAIN FLOOR

↑ ENTRANCE

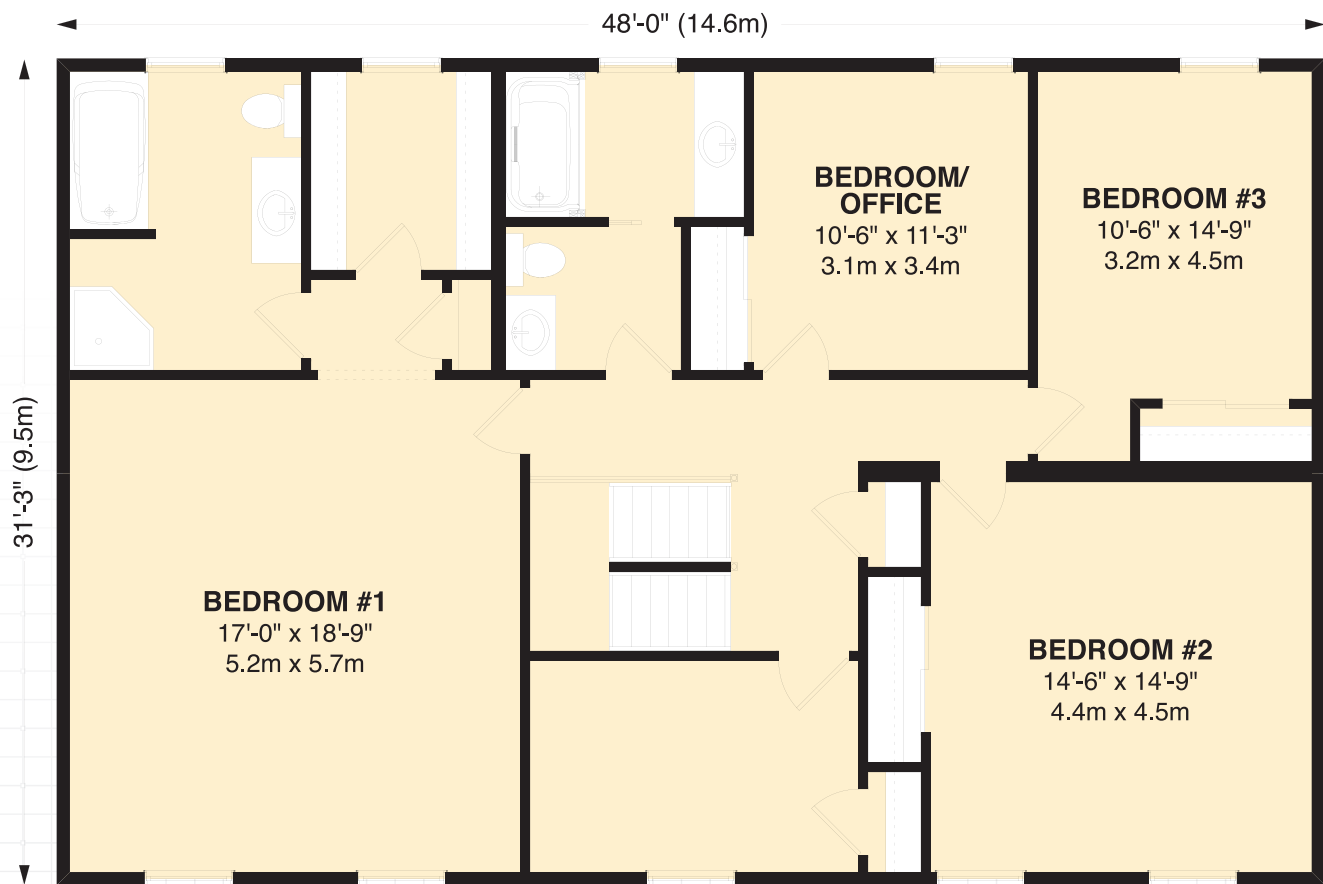

UPPER FLOOR