



THE BALALE

VACATION HOMES & COTTAGES

YOUR LOT, YOUR DREAM, CUSTOM BUILT.



OVERVIEW



1600 SQ. FT.*



3 BEDROOMS



2 BATHS

The Bala LE is the vacation home for your family cottage, making good use of every square inch of this home. To compliment your outdoor space, a screened-in porch has been added, allowing you to use your property to its full potential. A galley kitchen, open concept dining and living rooms are efficient and spacious. Three bedrooms, and two baths are ample space to have your family and friends come for a visit. Cathedral ceilings with rich wooden beams and panels return the flavour of the historic cottage we have come to cherish.

CUSTOMIZATION & OPTIONS:

- In the ensuite change from shower to soaker tub
- Engineered Hardwood throughout the main areas
- Add ceiling fans in the living room

RoyalHomes.com
1.800.265.3083

THE BALALE HIGHLIGHTS

- Screened-in Porch
- Galley Kitchen
- Open Concept Dining & Living rooms
- Three bedroom & two Baths
- Cathedral Ceilings & Wooden Beams

1600

SQ. FT.*

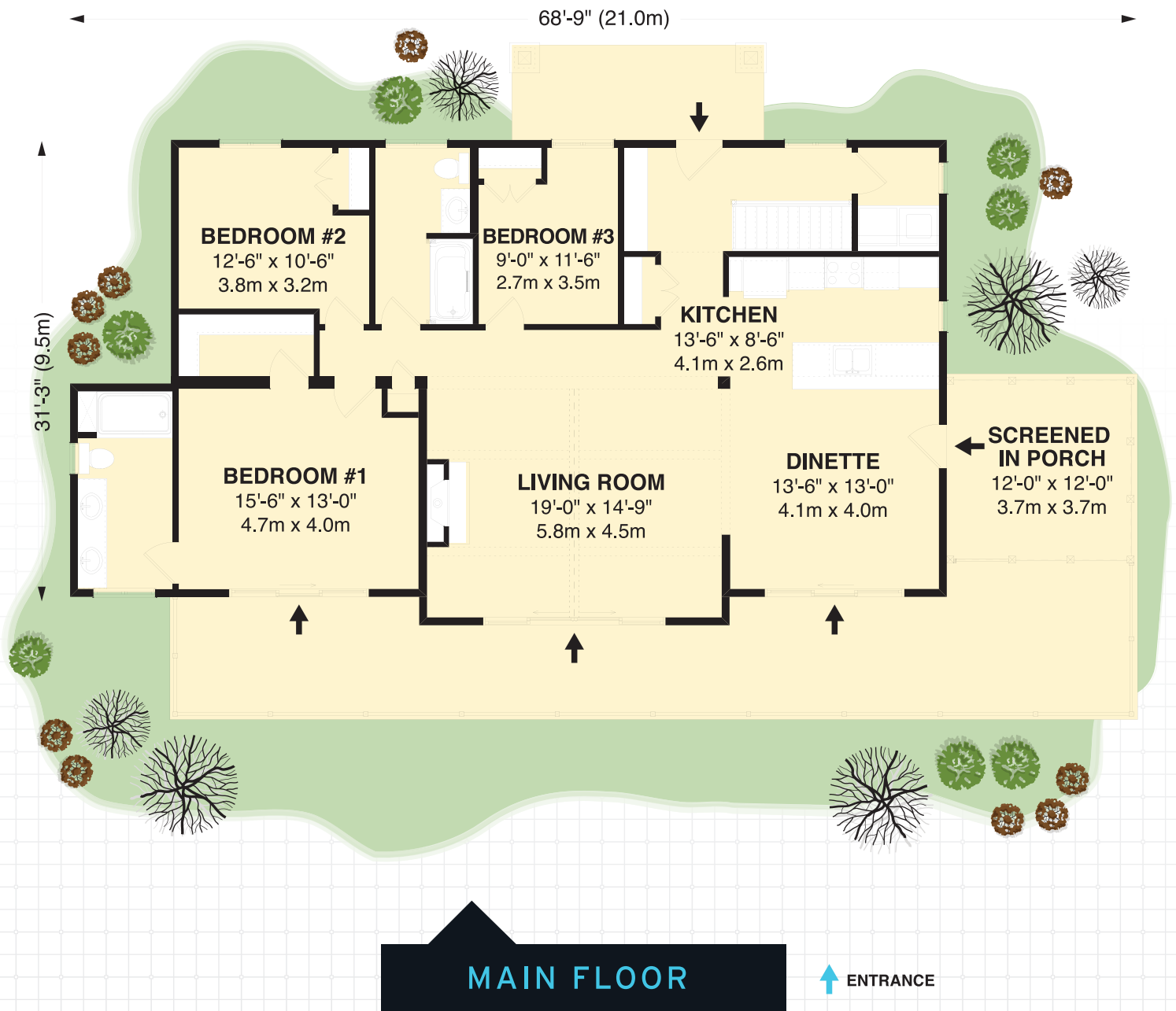

213 Arthur Street, P.O. Box 370 | Wingham, Ontario, Canada N0G 2W0
Tel: (519) 357.2606 | Toll Free: 1.800.265.3083 | E-mail: Royal@RoyalHomes.com
RoyalHomes.com

*Actual usable floor space may vary from stated floor area. Copyright by Royal Homes. All designs, floor plans and elevations contained herein are the exclusive property of Royal Homes. No home may be constructed in accordance with these plans, except as authorized in writing by the copyright owner. Plans are artist renderings only. For exact dimensions and specifications, please see blueprints.